

NOT TO SCALE

PROPOSED WORK SHOWN

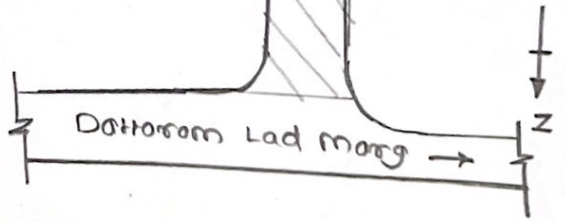

BRIHANMUMBAI MUNICIPAL CORPORATION			
Improvement of Krunhiyeer Bhai Bai Murtund Marg Asphalr Resurfacing / Dovers Slacks / In CC/CC Passage/TWT/UTWT in E Ward (City Zone 1)			
DRG NO: DY.Ch.E/RDS/CITY/E/		/Dtd.	
SE	AE	EE	DY Ch E(Rds) City

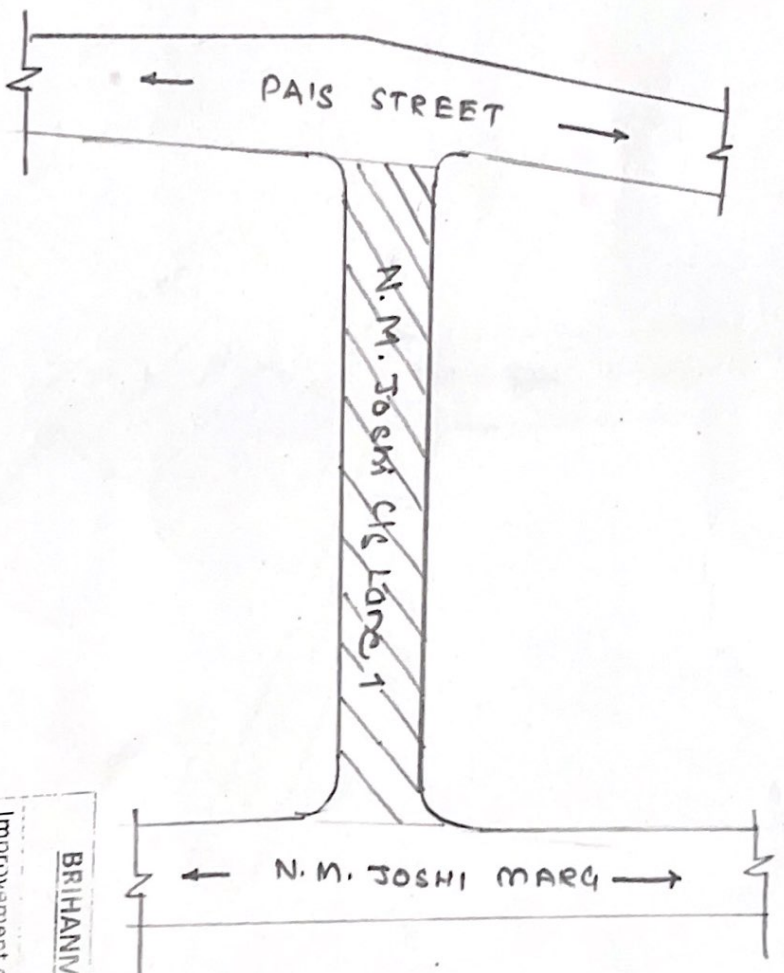

PROPOSED WORK SHOWN

NOT TO SCALE.

BRIHANMUMBAI MUNICIPAL CORPORATION			
Improvement of N.M. Joshi Cls Lane No.01			
In Resurfacing in Asp/As. E Ward (City Zone 1)			
DRG NO: D.V./C.I./E/RDS/CITY/E/		/Dtd.	
SE	AE	EE	D'Ch EIR/IS/City

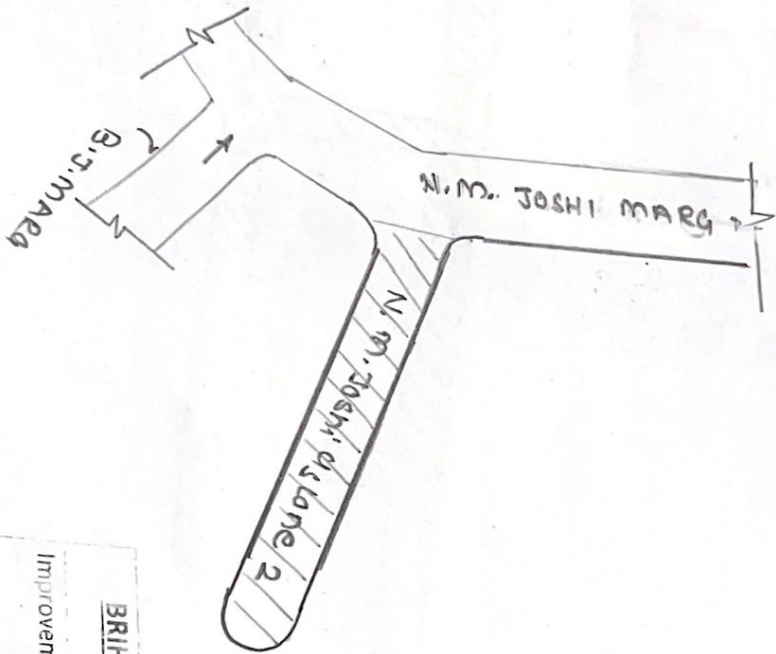

PROPOSED WORK SHOWN

NOT TO SCALE

<u>BRIHANMUMBAI MUNICIPAL CORPORATION</u>			
Improvement of N.M. Joshi Qs Lane No.2			
In Resurfacing in Aspfa. E Ward (City Zone1)			
DRG. NO.:	Dy.Ch. E/RDS/CITY/E/	/	Dtd.
SE	AE	EE	Dy. Ch E/RDS) City

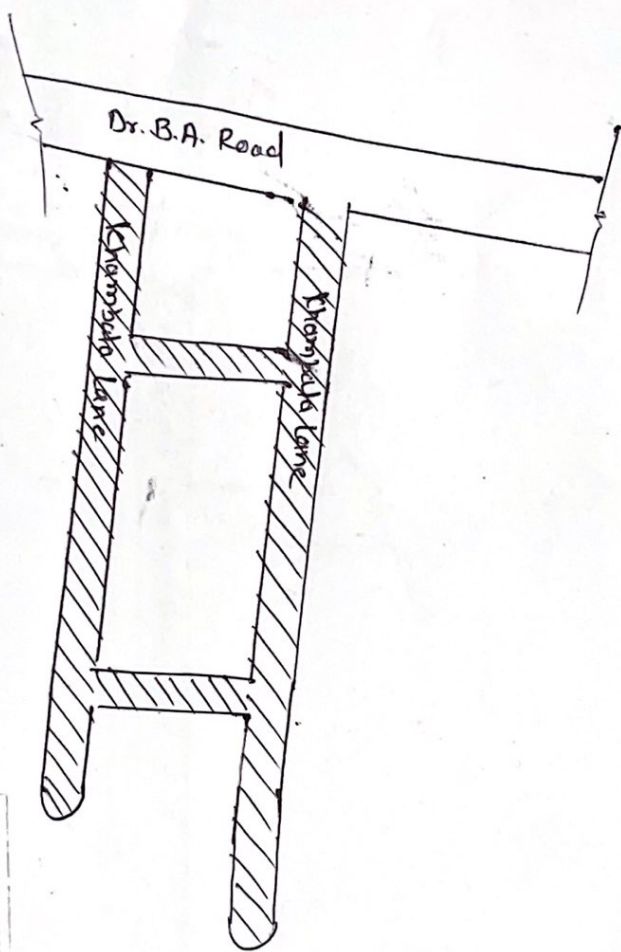

PROPOSED WORK SHOWN
 NOT TO SCALE

<u>BRIHANMUMBAI MUNICIPAL CORPORATION</u>			
Improvement of <i>Kharabde Lane</i>			
In Resurfacing in As/PA. E Ward (City Zone I)			
DRG NO.: DY. CI. E/RDS/CITY/E/		/Dtd.	
SE	AE	EE	DY Ch E(R/S) City

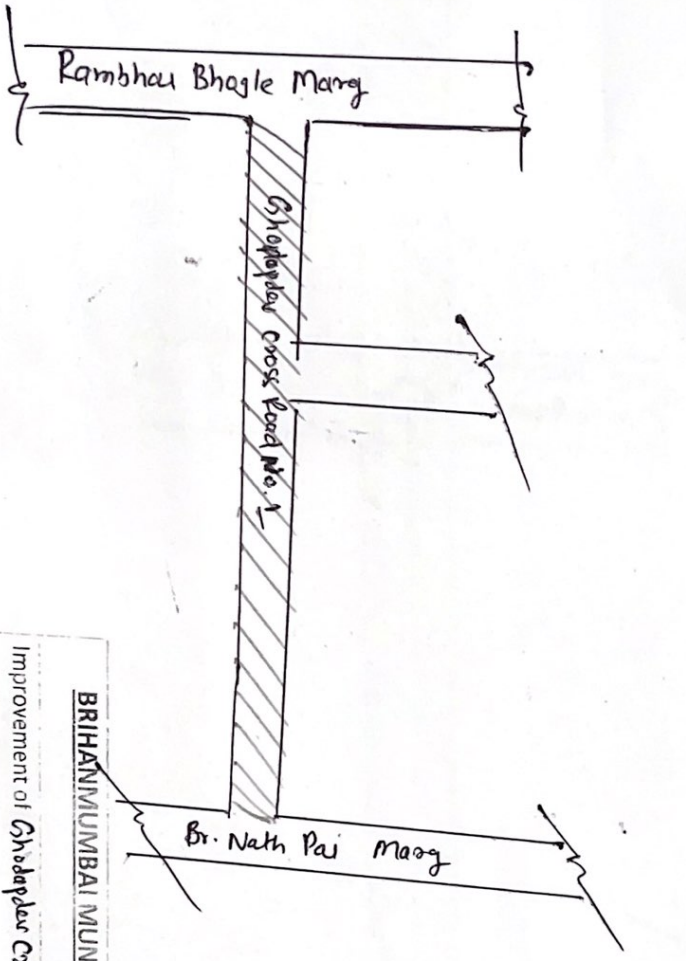



 PROPOSED WORK SHOWN

 NOT TO SCALE

BRIHANMUMBAI MUNICIPAL CORPORATION			
Improvement of Ghodapada Cross Road No. 1			
In Resurfacing in ASP/PA. E Ward (City Zone I)			
DRG NO: DY.CI.E/RDS/CITY/E/		/Dtd.	
SE	AE	EE	DY Ch E(RDS) CITY

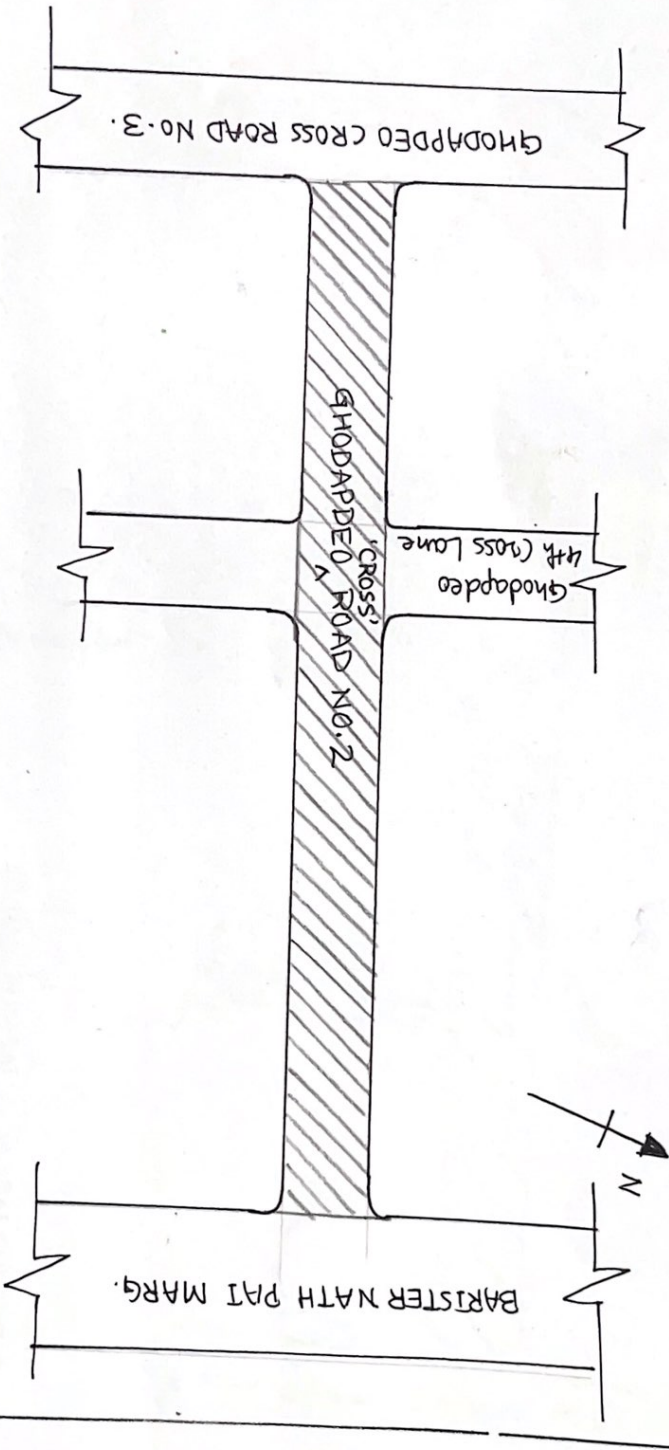

PROPOSED WORK SHOWN
NOT TO SCALE.

BRIHANMUMBAI MUNICIPAL CORPORATION
Improvement of **Ghodapdeo Cross Road no. 2.**
In **Resurfacing in ASP/PA. E Ward (City Zone I)**
DRG. NO: **DY.CH. E/RDS/CITY/E/** /Dtd.
SE AE EE D Ch E(Rds) City

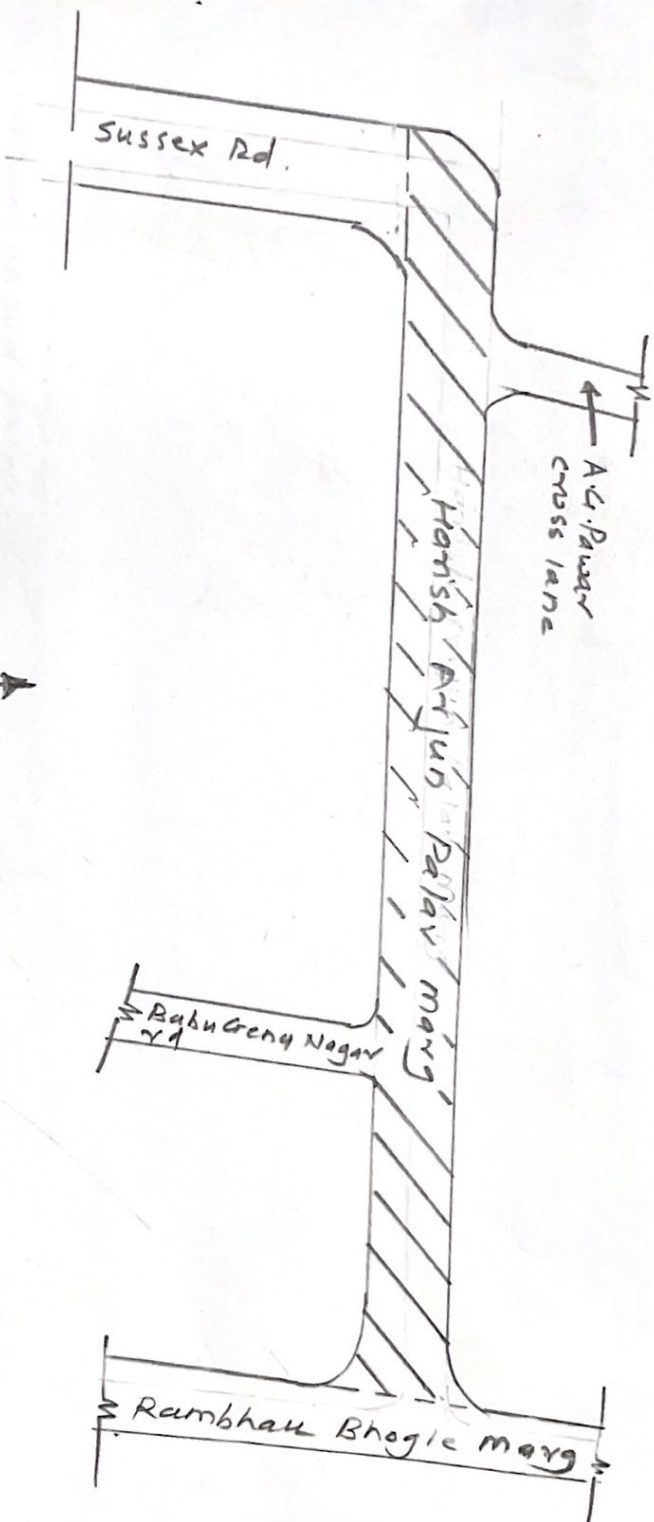

PROPOSED WORK SHOWN
 NOT TO SCALE



BRIHANMUMBAI MUNICIPAL CORPORATION			
Improvement of Hansh Arjun Palav Marg			
In Resurfacing in ASP/PA. E Ward (City Zone I)			
DRG NO:	DY CL. E/RDS/CITY/E/	/	Dist.
SE	AE	EE	D- Ch E(R/S) City

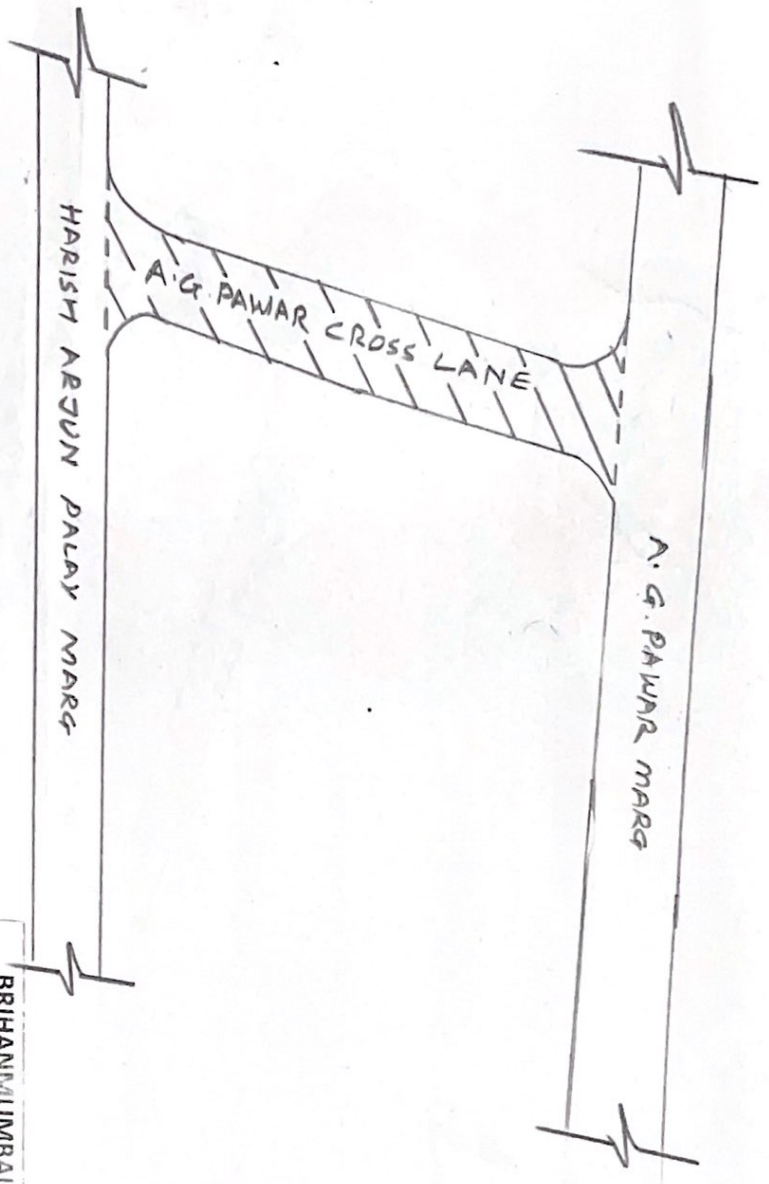

PROPOSED WORK SHOWN

NOT TO SCALE

BRIHANMUMBAI MUNICIPAL CORPORATION

Improvement of Anant Ganpat Pawar Cross Lane

In Resurfacing in Asp/PA. E Ward (City Zone 1)

DRG NO: Dy.Ch.E/RDS/CTY/E/ /Dtd.

SE AE EE Dy.Ch.E(Rds) City



PROPOSED WORK SHOWN
Sketch not to scale

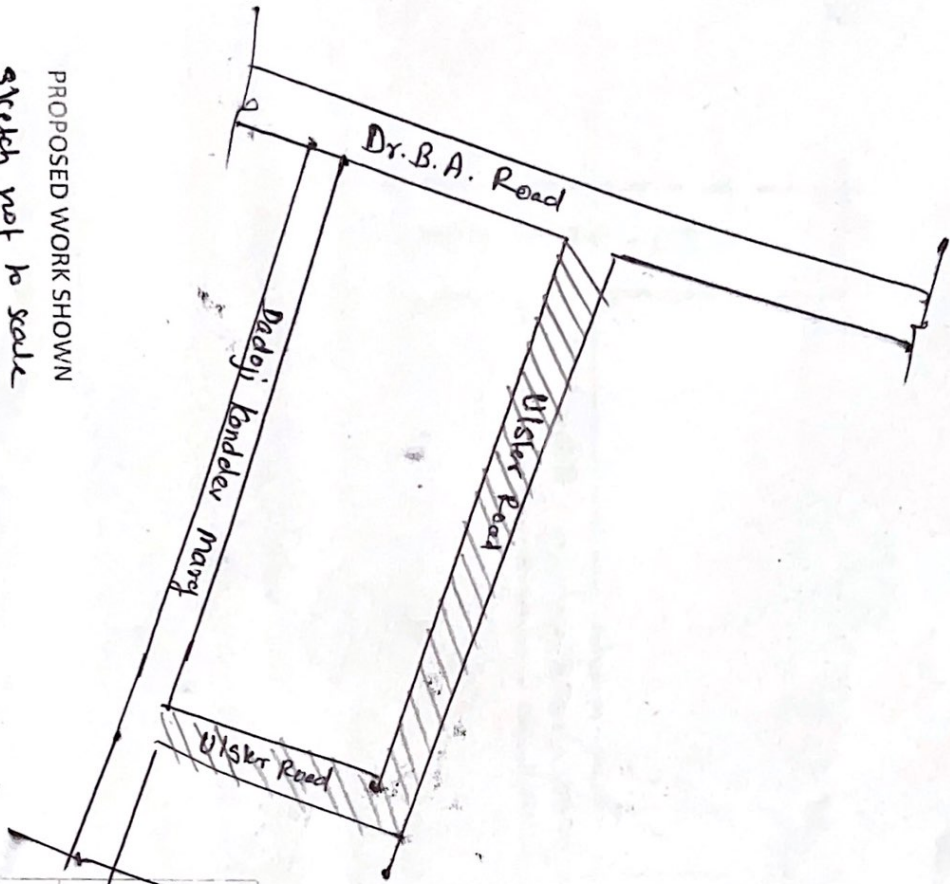

BRIHANMUMBAI MUNICIPAL CORPORATION			
Improvement of Ulsar Road			
in Resurfacing in ASP/PA. E Ward (City Zone 1)			
DRS NO: Dv, Ch. E./RDS/CITY/E/	/	DiD.	
SE	AE	EE	DV/CH E(R/S) CITY

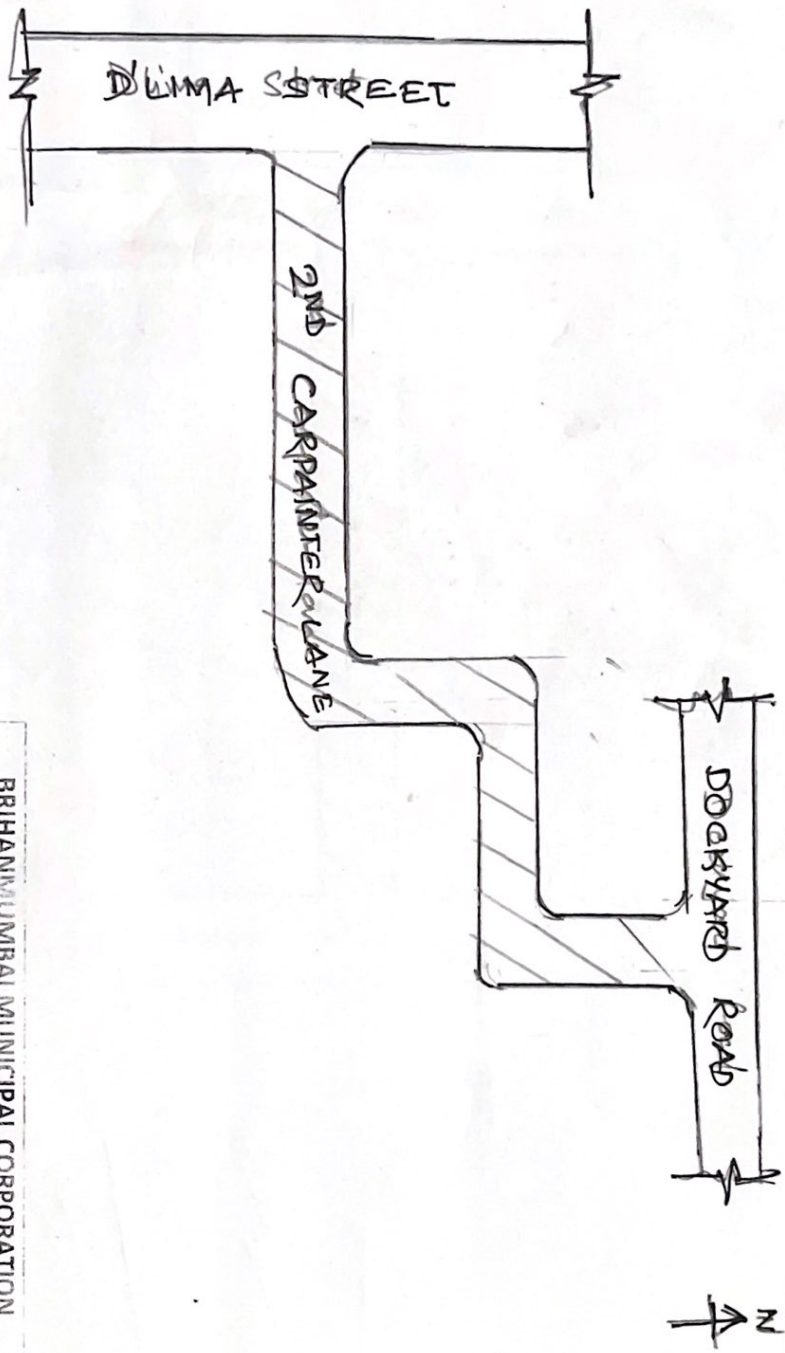

PROPOSED WORK SHOWN
 NOT TO SCALE



BRIHANMUMBAI MUNICIPAL CORPORATION

Improvement of **2ND CARPAINTER LANE**
Resurfacing Asphalt
 In E/C/C Passenger ~~Area~~ in E Ward (City Zone I)

DRG NO: DY./Ch./E/RDS/CITY/E/ /Dtd.

SE AD FE D'Ch/Fl/Ro IV

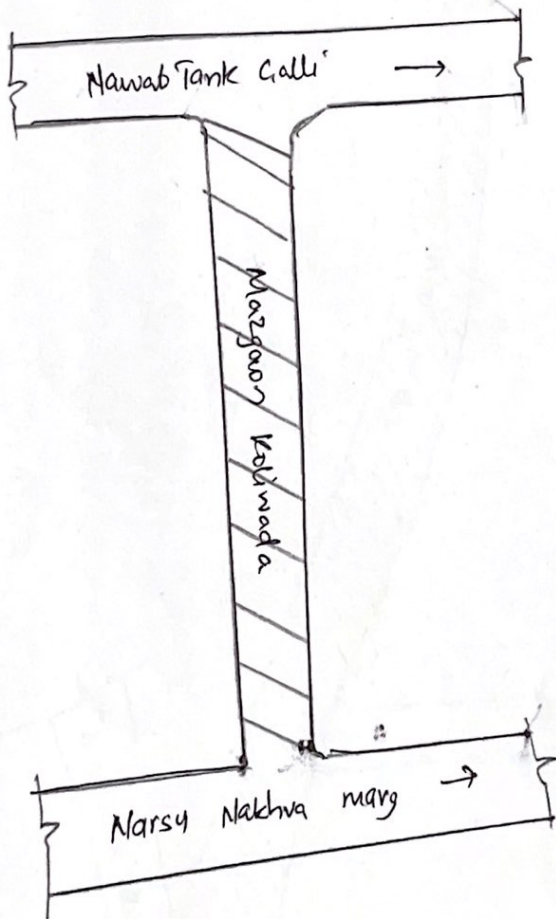

①



PROPOSED WORK SHOWN

NOT TO SCALE

BRIHANMUMBAI MUNICIPAL CORPORATION

Improvement of **Mazgaon Koliwada road**
 in Resurfacing in ASP/PA. E Ward (City Zone 1)

Drawn NO: DY.Ch.E/RDS/CITY/E/ / Dtd.

SE AE EE DY.Ch.E(R.S) CITY

Rambhau Bhogle Marg

Champsī Bhinjī Marg

R.S. Naik Road



PROPOSED WORK SHOWN

NOT TO SCALE.

BRIHANMUMBAI MUNICIPAL CORPORATION

Improvement of Champsī Bhinjī Marg.

In Resurfacing in ASRP/3, E Ward (City Zone I)

DRG NO: Dy.Ch.E/RDS/CITY/E/ /Dtd.

SE AE EE Dy.Ch E(Rts) CITY

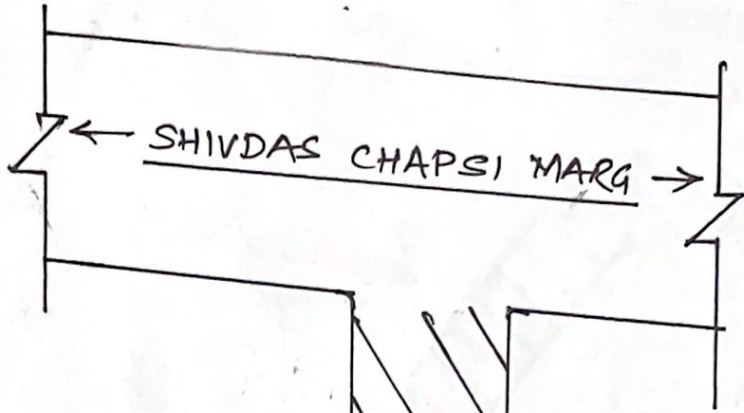

PROPOSED WORK SHOWN

K19



BHAGWAN ADINATH ROAD.

NOT TO SCALE

BRIHANMUMBAI MUNICIPAL CORPORATION

Improvement of **BHAGWAN ADINATH ROAD**

In Resurfacing in Asf/Pa. E Ward (City Zone1)

DRG NO: Dy. Ch. E/RDS/CITY/E/ /Dtd.

SE AE EE D - Ch (E/R/S) CITY

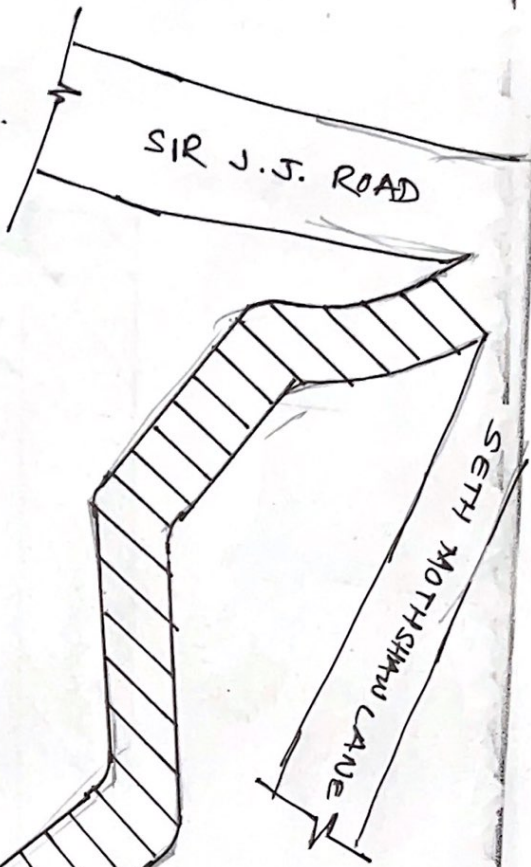

PROPOSED WORK SHOWN
NOT TO SCALE

BRIHANMUMBAI MUNICIPAL CORPORATION			
Improvement of HANSRAJ LANE			
In Resulting in Aspp/A. E Ward (City Zone I)			
DRG NO: DY. CH. E/RDS/CITY/E/	/	DIID.	/
SE	AE	EE	DY CH ETR(S) CITY

(14)

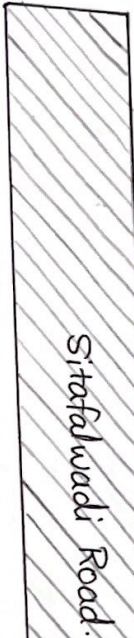

PROPOSED WORK SHOWN
 NOT TO SCALE.

BRIHANMUMBAI MUNICIPAL CORPORATION			
Improvement of Sitafalwadi Road.			
In Resurfacing in AS/PA. E Ward (City Zone-I)			
DRG NO: DY.Ch. E/RDS/CITY/E/	/Dtd.		
SE	AE	EE	D. Ch E(Rds) City

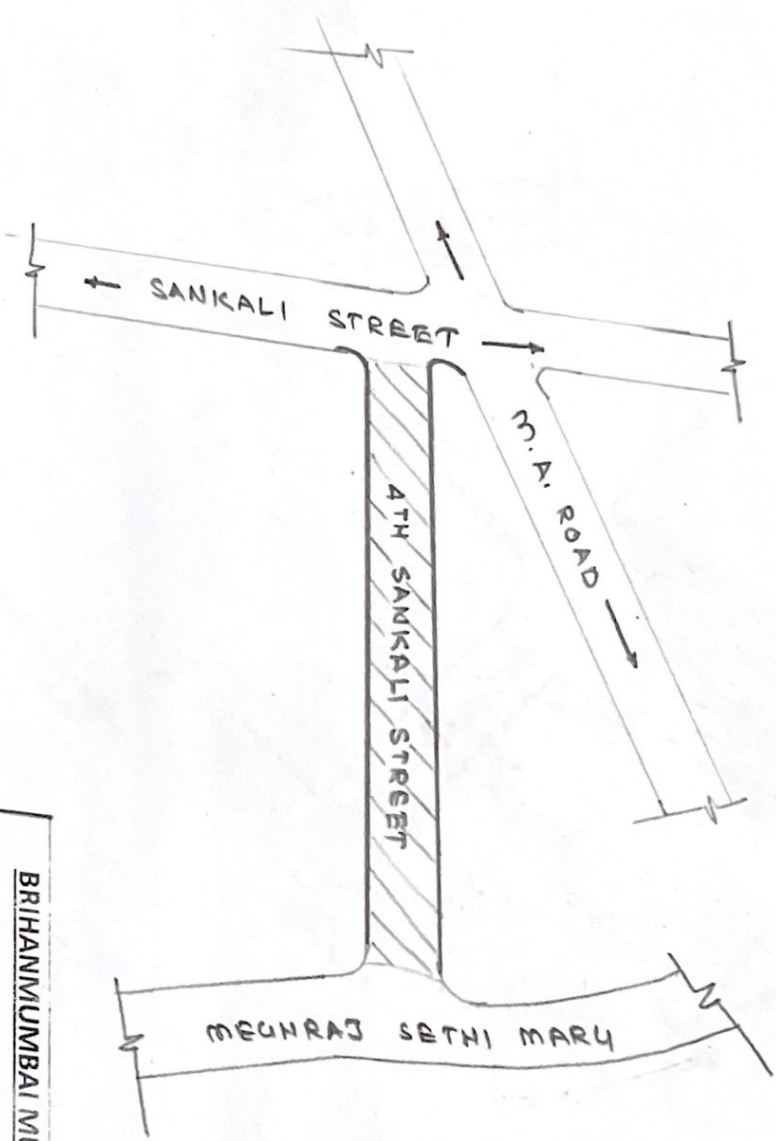

 PROPOSED WORK SHOWN
 NOT TO SCALE.

BRIHANMUMBAI MUNICIPAL CORPORATION				
Improvement of 4TH SANKALI STREET				
In Resurfacing in ASP/PA. E Ward (City Zone I)				
DRG NO: DY.Ch. E/RDS/CITY/E/		/Dtd.		
SE	AE	EE	DY Ch E(RDS) City	

 PROPOSED WORK SHOWN
 NOT TO SCALE

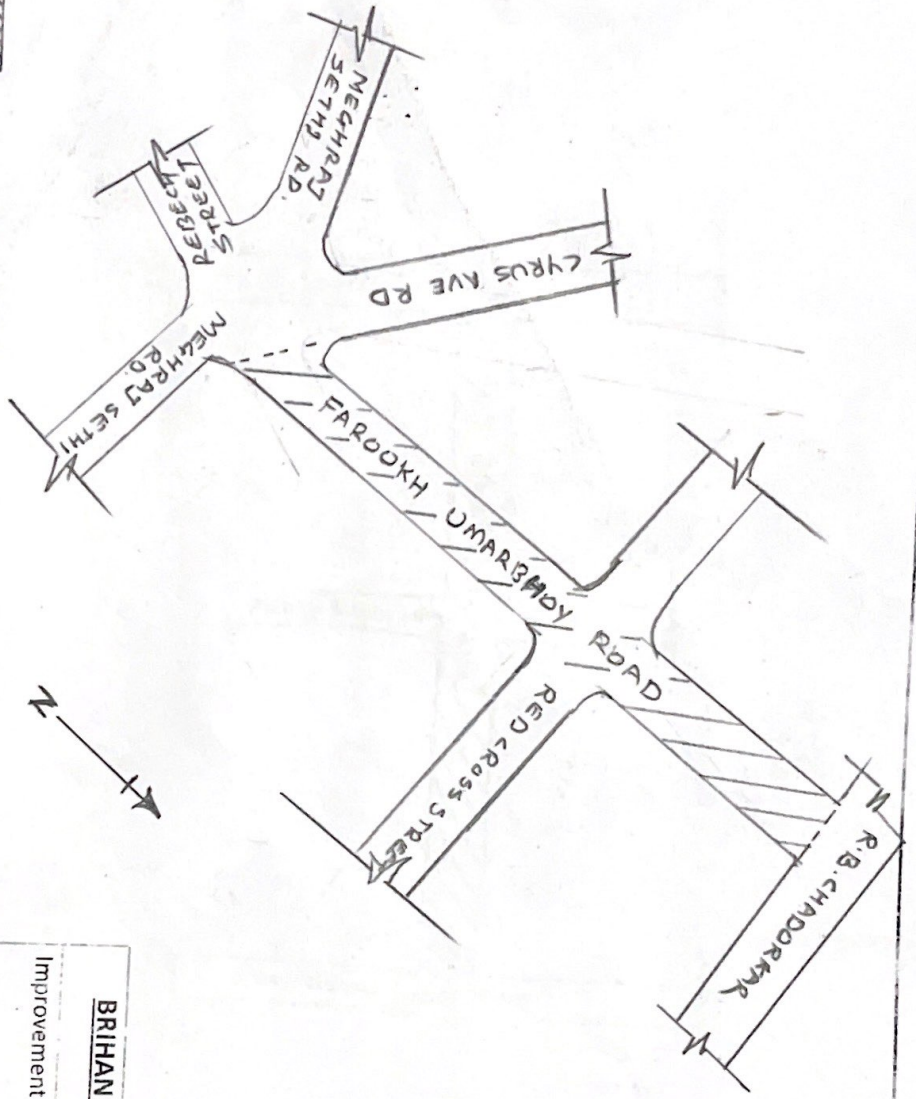

BRIHANMUMBAI MUNICIPAL CORPORATION			
Improvement of FAROOKH UMARBHAI ROAD			
In Resurfacing in ASP/PA, E Ward (City Zone 1)			
DRG NO: DY.Ch.E./RDS/CITY/E/		/Dtd.	
SE	AE	EE	DY.Ch.E(RDS) City

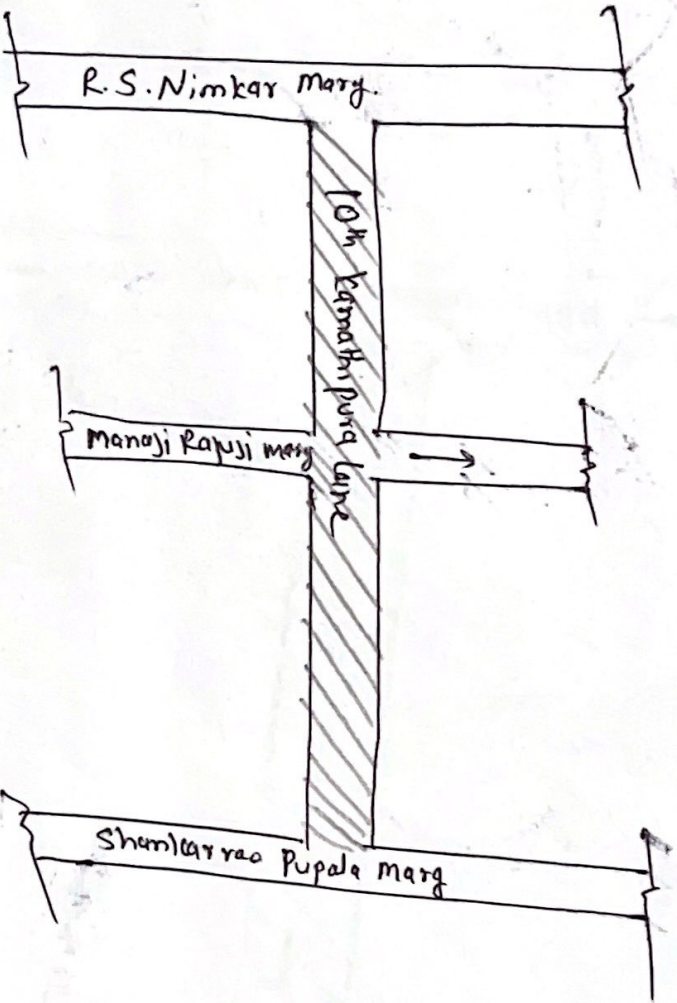

PROPOSED WORK SHOWN
 Spoken to scale

BRIHANNUMBAI MUNICIPAL CORPORATION			
Improvement of 10th Karanahi Pura Marg			
In Resurfacing in ASP/PA. E Ward (City Zone I)			
DRG NO: D.V./C.I./E/RDS/CITY/E/	/Dtd.		
SE	AE	EE	Dy. Ch E(R/S) City

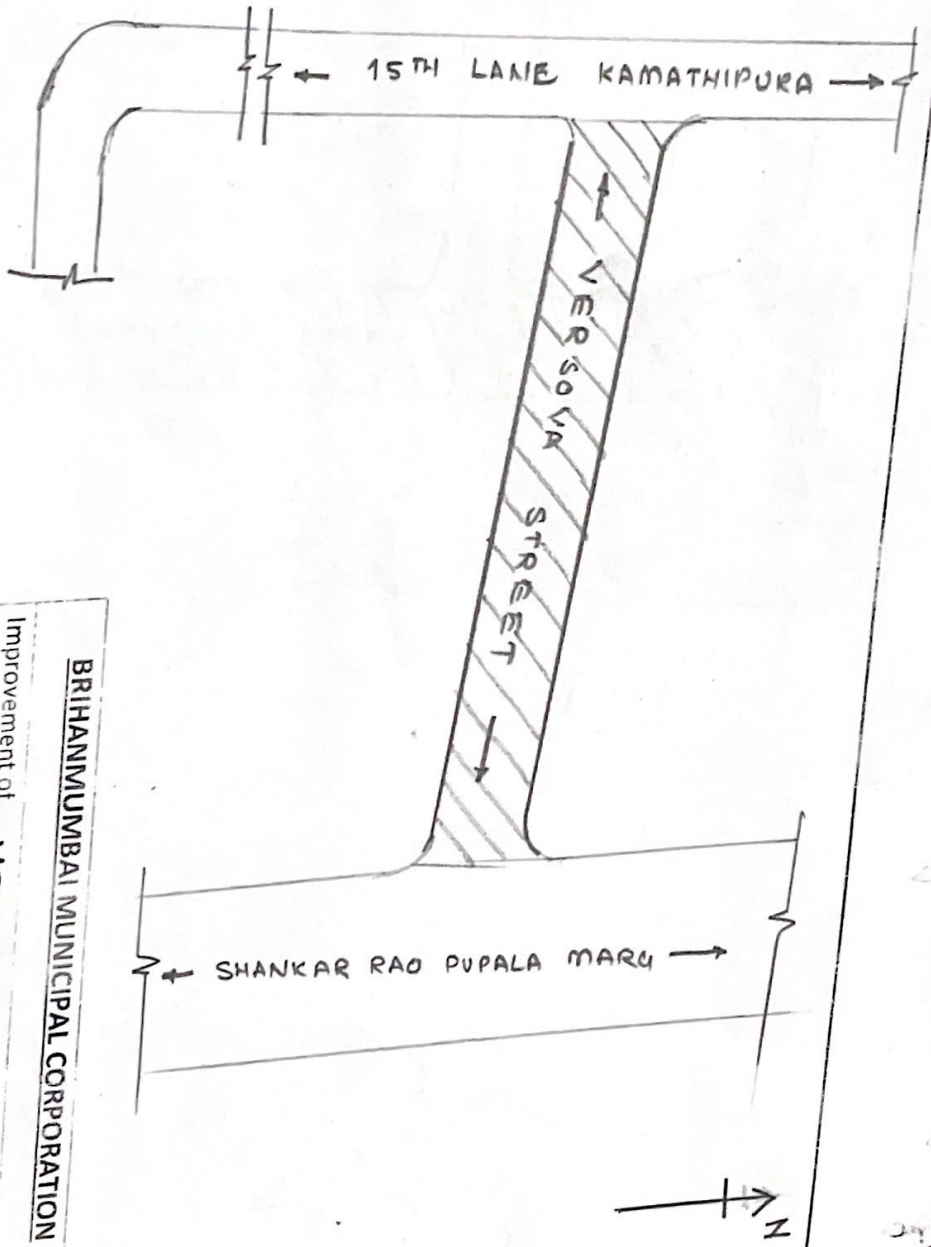

PROPOSED WORK SHOWN

NOT TO SCALE.

BRIHANMUMBAI MUNICIPAL CORPORATION			
Improvement of VERSOVA STREET			
In Resurfacing in AsP/Pr. E Ward (City Zone I)			
DRG NO: Dy.Ch.E/RDS/CITY/E/		/Dtd.	
SE	AE	EE	Dy.Ch E(RDS) City

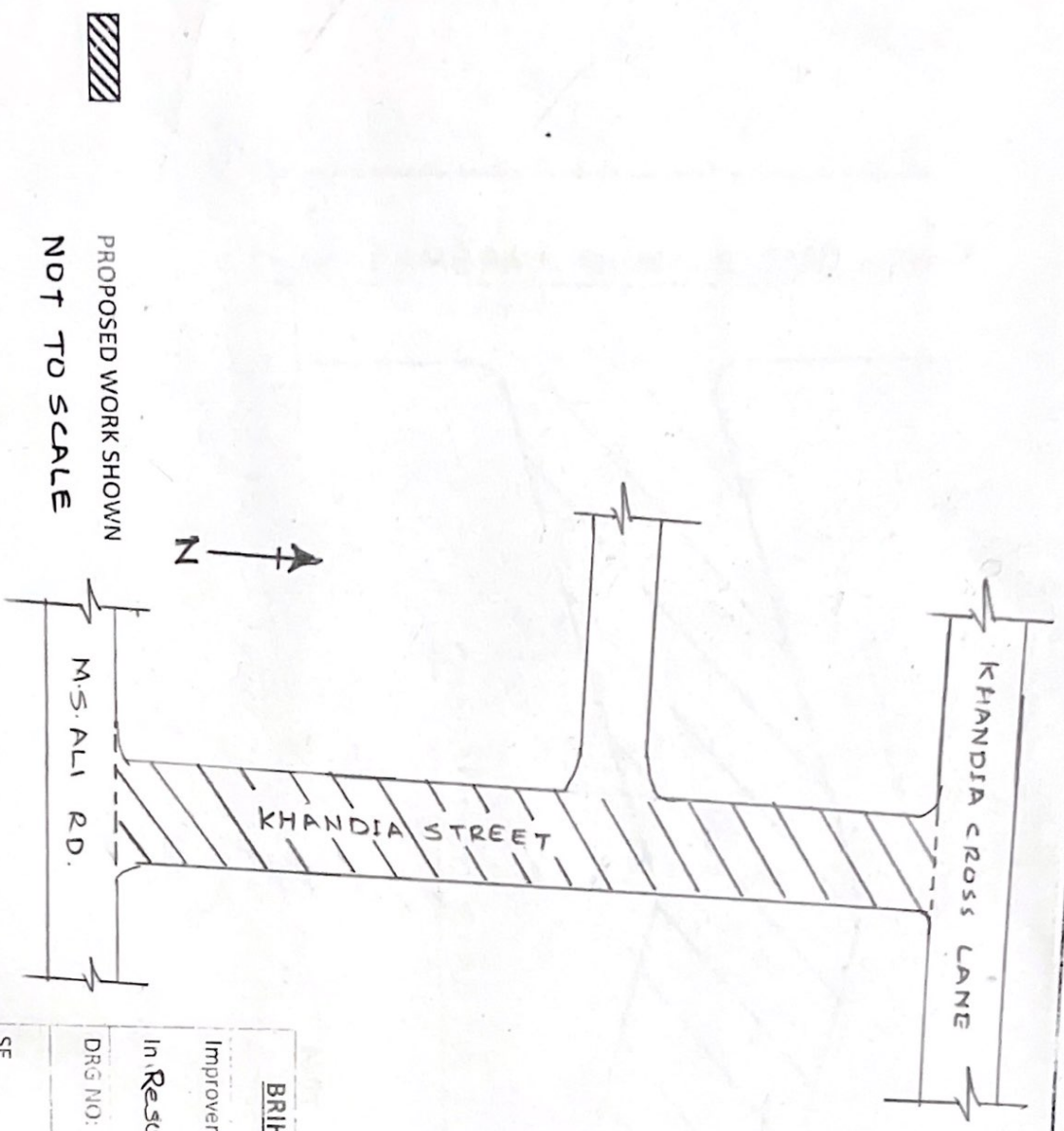

PROPOSED WORK SHOWN
NOT TO SCALE

BRIHANMUMBAI MUNICIPAL CORPORATION			
Improvement of KHANDIA STREET			
In Resurfacing in As/Pr. E Ward (City Zone 1)			
DRG NO: Dy.Ch.E/RDS/CITY/E/	/Dtd.		
SE	AE	EE	Dy Ch E(Rds) City

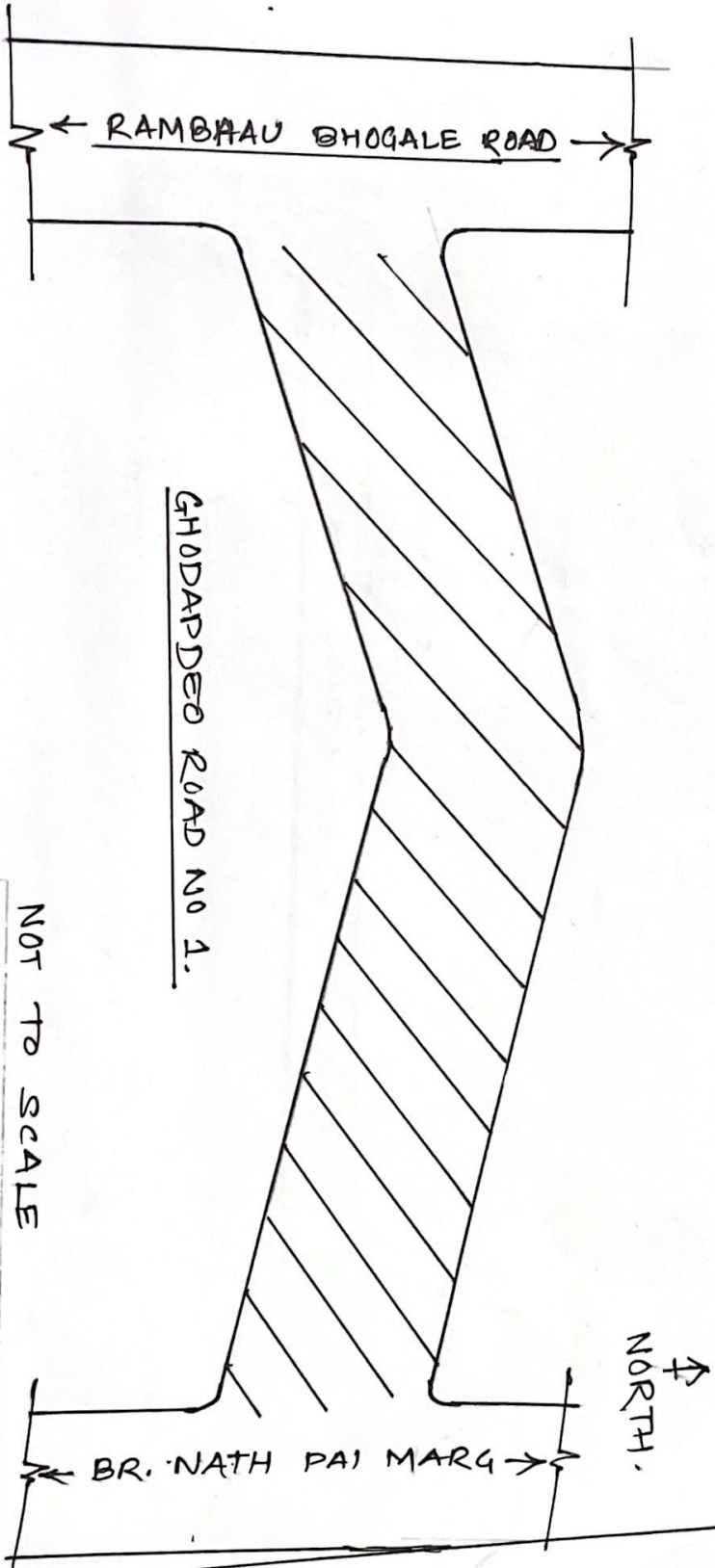

GHODAPDEO ROAD NO 1.

← RAMBHAU BHOGALE ROAD →

← BR. NATH PAI MARG →

↑ NORTH ↓



PROPOSED WORK SHOWN

NOT TO SCALE

BRIHANMUMBAI MUNICIPAL CORPORATION

Improvement of GHODAPDEO ROAD NO 1.

In Resurfacing in ASP/PA. E Ward (City Zone1)

DRG NO: DY.CH.E/RDS/CITY/E/ /Dtd.

SE AE EE DY CH E(Rds) City

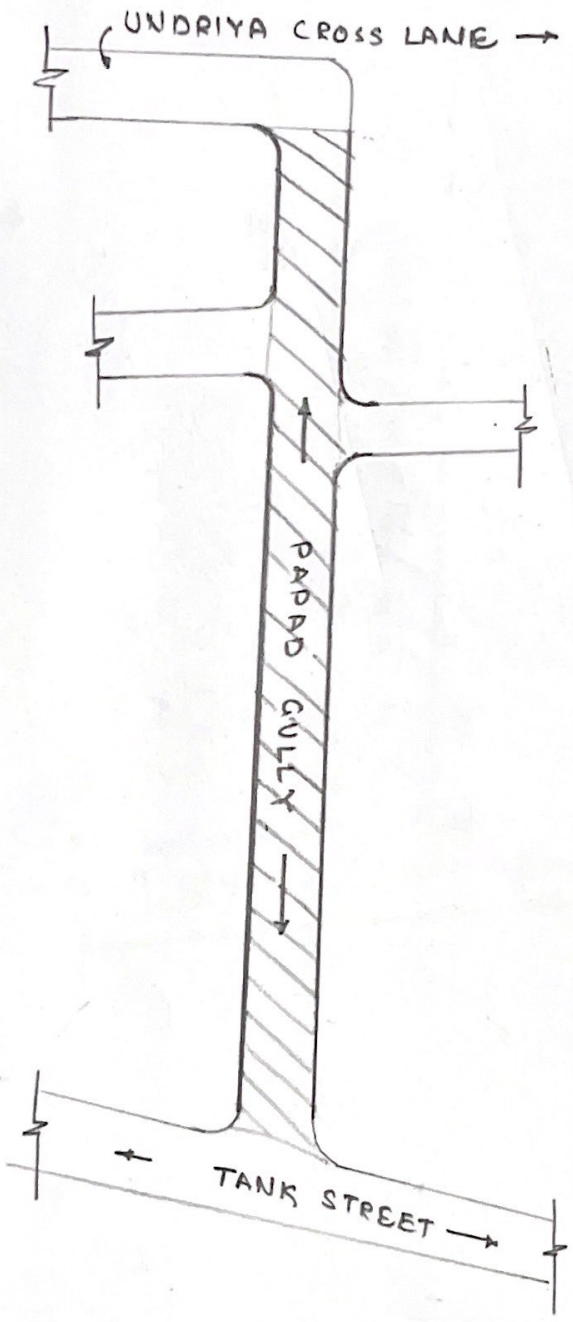

 PROPOSED WORK SHOWN
NOT TO SCALE

BRIHANMUMBAI MUNICIPAL CORPORATION			
Improvement of PAPAD GULLY			
In Resurfacing in ASP/PA. E Ward (City Zone I)			
DRG NO:	DY. CH. E/RDS/CITY/E/	/Dtd.	
SE	AE	EE	DY. CH. E(RDS) CITY

PB-2

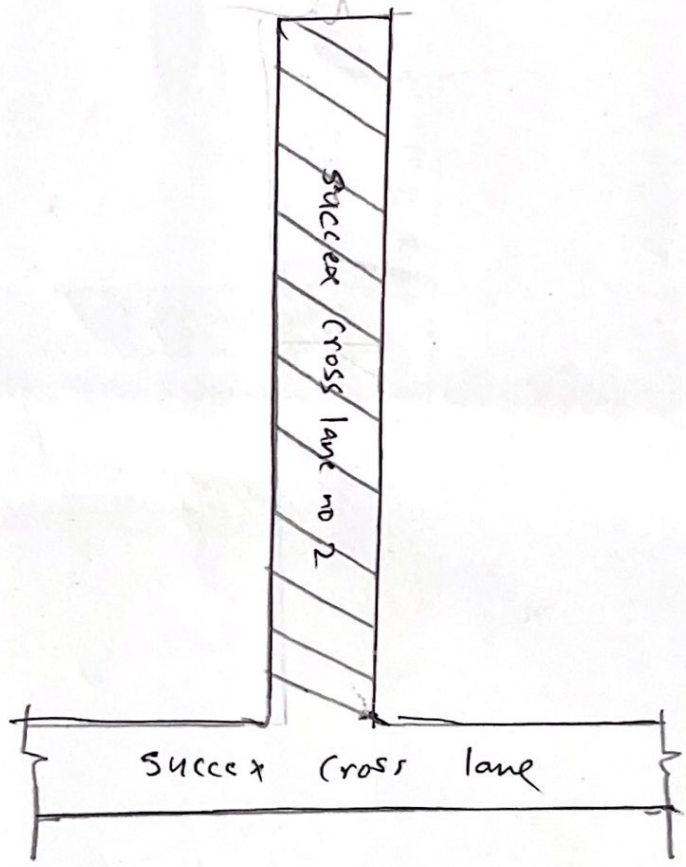

PROPOSED WORK SHOWN
NOT TO SCALE

BRIHANMUMBAI MUNICIPAL CORPORATION				
Improvement of Succex Cross lane no 2				
In Resurfacing in ASP/PA. E Ward (City Zone 1)				
DRG NO:	Dy.Ch. E/RDS/CITY/E/	/Dtd.		
SE	AE	EE	Dy. Ch. E/R/S/	CITY



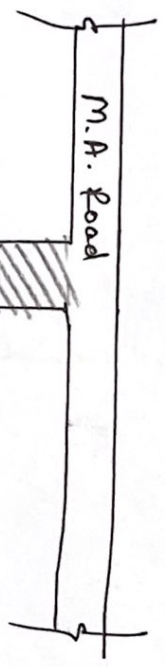

PROPOSED WORK SHOWN
Scale not to scale

BRIHANMUMBAI MUNICIPAL CORPORATION			
Improvement of <i>Rangunawala Compound</i>			
In Resurfacing in <i>Asp/Pr. E Ward (City Zone I)</i>			
DRG NO:	DY.CH. E/RDS/CITY/E/	/Dtd.	
SE	AE	EE	DY CH E(RDS) CITY